

DISC FLOOR SANDER MODEL HT7-2

From Serial Number
00466 (110/120 Volt)



OWNERS MANUAL & OPERATING INSTRUCTIONS

DISC FLOOR SANDER MODEL HT7-2

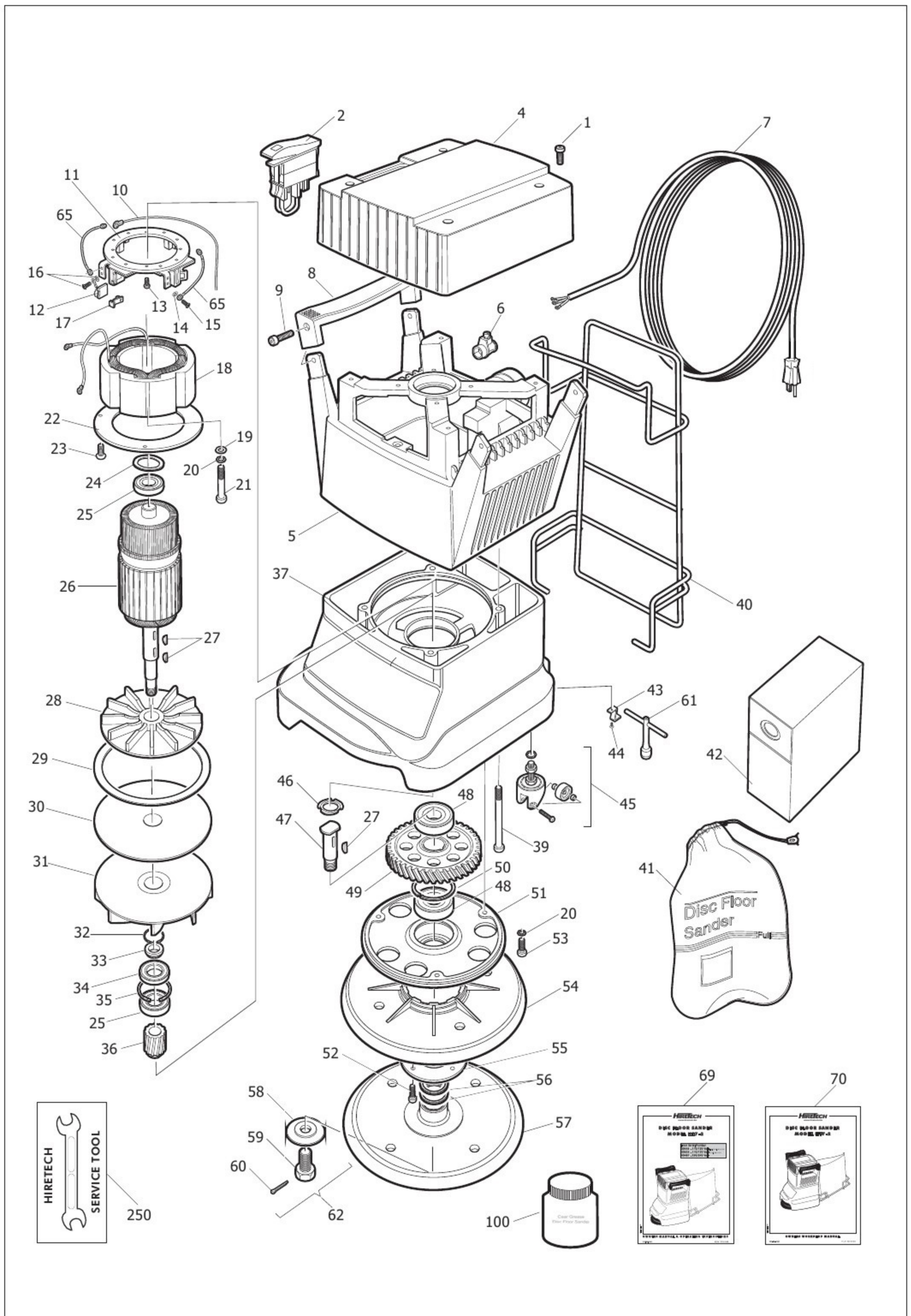

DISC FLOOR SANDER MODEL HT7-2

Ref.	PSTK	Pack Qty.	Description	Ref.	PSTK	Pack Qty.	Description
1	010010	4	Screw	54	010620	1	Guard Disc
2	011610	1	Switch 110/120 Volt (Bias Off)	55	010630	1	Retainer
4	010050	1	Cover Motor	56	010640	4	Shim
5	010070	1	Housing Motor	57	012310	1	Sanding Pad (Metal Backed)
6	010080	1	Strain Relief	58	010660	1	Washer Clamp
7	010100	1	Cable Main 110 Volt (NA)	59	010670	1	Bolt Clamp
8	010140	2	Handles Pack of 2	60	010680	1	Pin Cotter
9	010150	4	Screw Handle	61	010690	1	Wrench
10	010160	1	Cable Switch Assembly	62	010720	1	Washer, Clamp and Pin Cotter Kit
11	010170	1	Brush Block Assembly	65	010750	2	Brush Shunt
12	010180	4	Brush Motor	69	011680	1	Owners Manual & Operating Instructions
13	010190	4	Screw Pack of 4	70	011820	1	Owners Workshop Manual
14	010200	4	Washer				
15	010210	4	Screw				
16	010220	4	Screw and Washer Set				
17	010230	4	Brush Spring				
18	010240	1	Field 110/120 Volt HT7				
19	010260	2	Washer Clamp				
20	010270	5	Washer Lock				
21	010280	2	Screw				
22	010290	1	Baffle				
23	010300	3	Screw				
24	010600	1	Spring Washer				
25	010320	2	Bearing				
26	010330	1	Armature 110/120 Volt				
27	010350	3	Key				
28	010360	1	Fan Motor				
29	010370	1	Gasket				
30	010380	1	Plate Exhaust				
31	010390	1	Fan Intake				
32	010400	1	Ring Retainer				
33	010410	1	Spacer Bearing				
34	010420	1	Seal				
35	010430	1	Ring Retainer				
36	010440	1	Pinion				
37	010450	1	Housing Gear				
39	010470	4	Screw				
40	010480	1	Frame Bag Support				
41	010490	1	Bag Dust Cloth				
42	07038	25	Disposable Paper Dust Bag HT7/HTF Pack 2 (box 25)				
42	07040	50	Disposable Paper Dust Bag HT7/HTF (box 50)				
43	010510	2	Clip Wrench				
44	010520	2	Screw				
45	010530	2	Castor & Nut				
46	010540	1	Spring Load				
47	010550	1	Shaft Drive				
48	010560	2	Bearing				
49	010570	1	Gear Drive				
50	010580	1	Ring Retaining				
51	010590	1	Cover Gear				
52	010220	4	Screw & Washer Set				
53	010610	3	Screw				

The following items are not illustrated.

Special Tools

250	011720	1	Service Tool - Castor Adjuster
250	011730	1	Service Tool - Sanding Pad Fitting/Removal H/D
250	011731	1	Service Tool - Sanding Pad Fitting/Removal
250	011740	1	Service Tool - Pinion Fitting/Removal
250	011850	1	Service Tool - Extractor Gear Cover
250	011860	2	Service Tool - Extractor Seal

Consumables

110	010760	1	Carton Transit
100	011270	1	Grease Gear Disc Floor Sander

HT7-2 CIRCUIT DIAGRAM

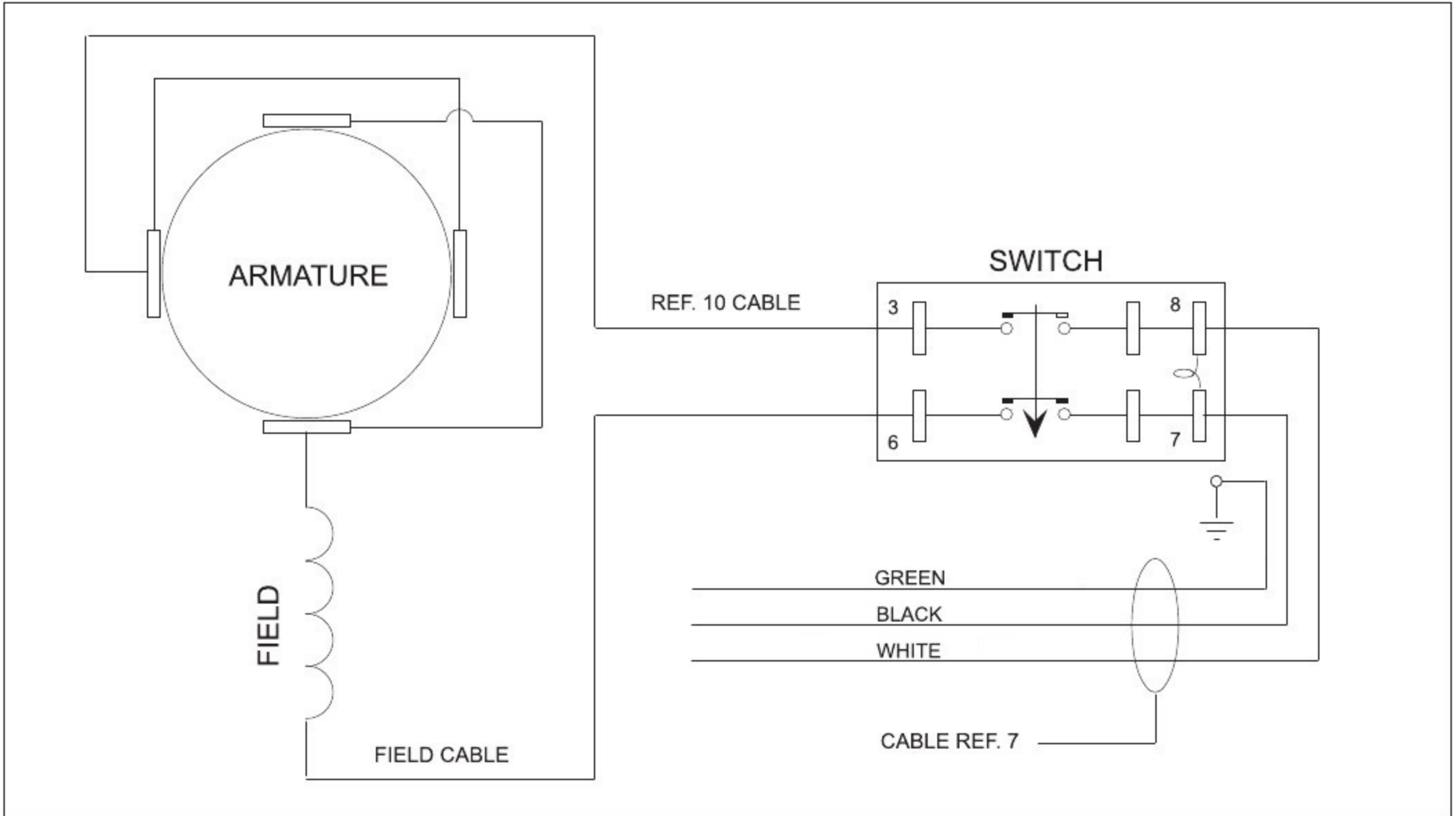

DELTAQUIP
www.deltaquip.ca (604) 298-8996 SUPPLIES LTD.