

# CABLE REPLACEMENT INSTRUCTIONS continued

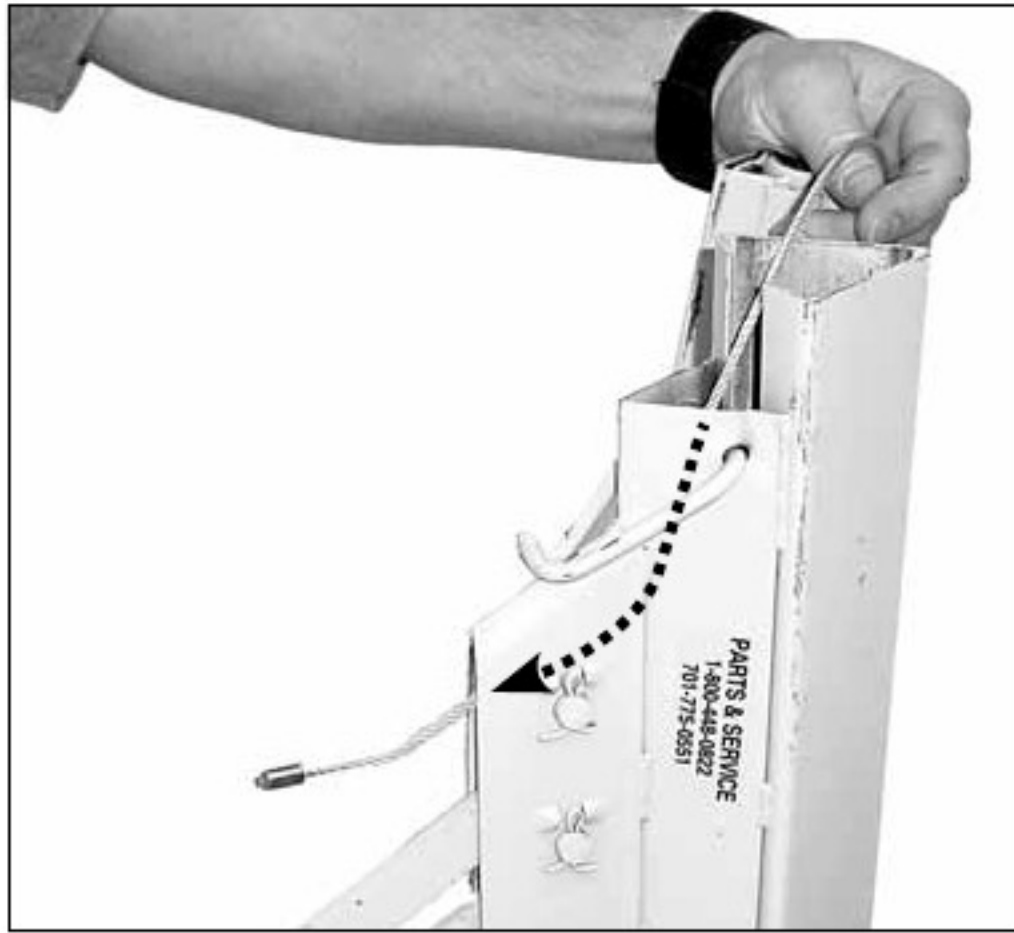

Front View

7. To reinstall the assembled telescoping sections, feed the crimped end of the cable through the frame sheave pocket from the top and over the top of the sheave as shown. (Model 182 go to page 13)

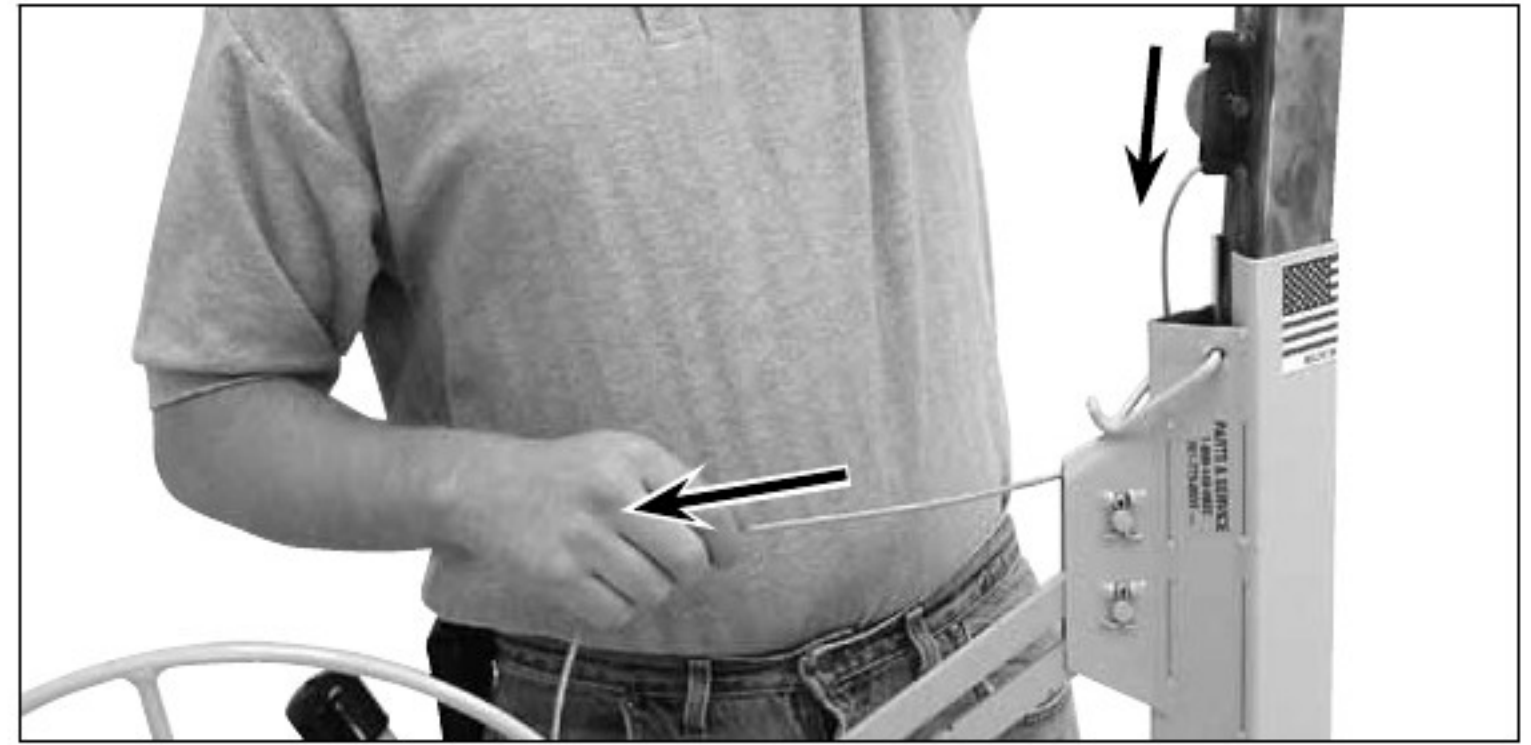

8. Pull the slack cable through the sheave pocket and slide the telescoping sections into the frame housing. As the telescoping sections lower into the frame, the slack cable will be drawn back up over the sheave.

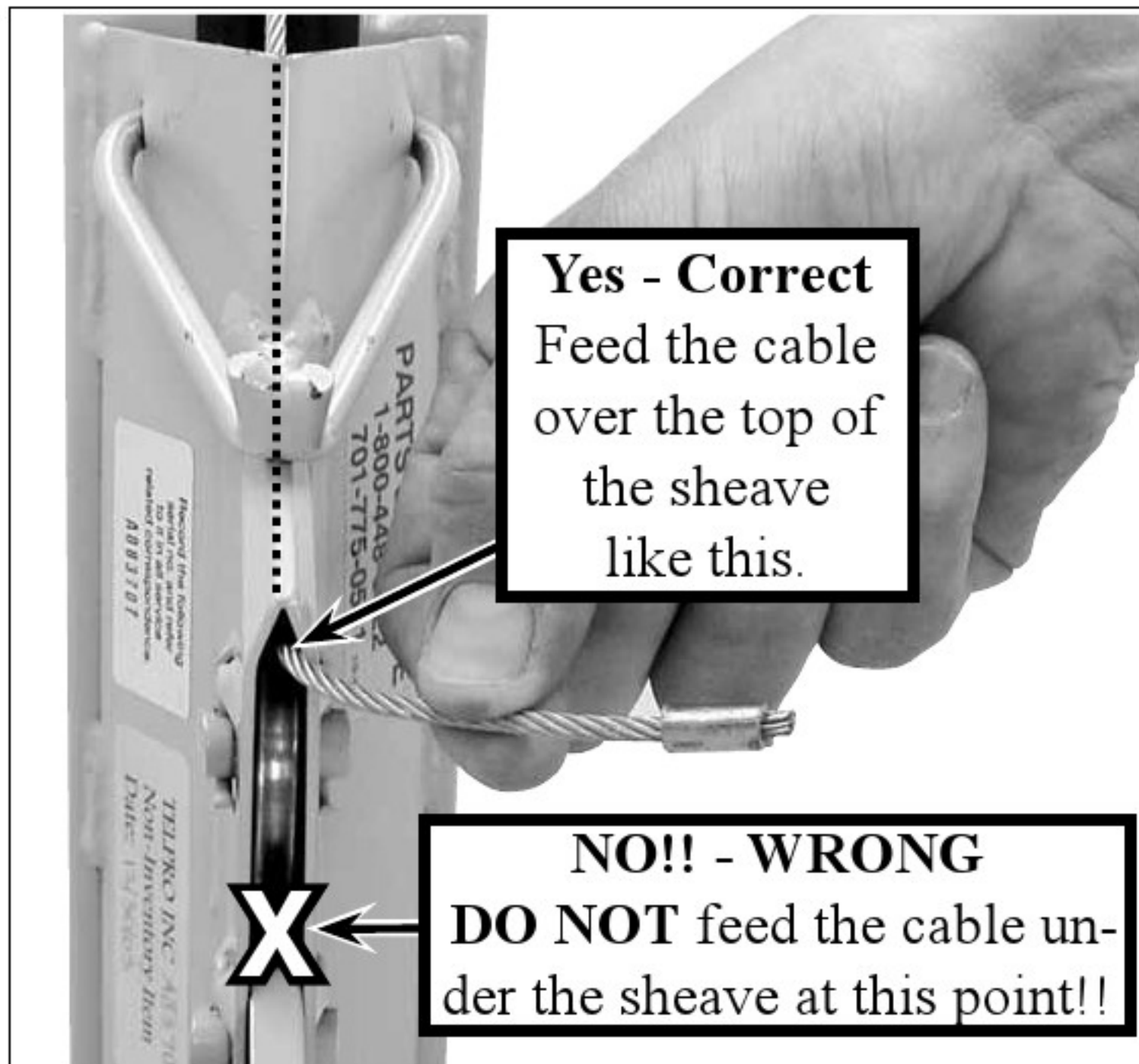

**Yes - Correct**  
Feed the cable over the top of the sheave like this.

**NO!! - WRONG**  
DO NOT feed the cable under the sheave at this point!!



9. Feed the crimped end of the cable through the hole in the winch drum and secure it behind the mooring tab by hand pulling the cable snug as shown.



**DO NOT** feed the cable under the cable sheave on the frame as shown in this photo!

## ⚠ WARNING ⚠

The cable **MUST** feed down from the top of the frame housing and over the top of the sheave exactly as shown in step 7 in order to function properly. Failure to install the cable correctly as shown can cause wearing of the cable for which it is not designed which can result in failure of the cable. Failure of the cable while the lift is raised will result in a sudden and rapid lowering of the lift and the load possibly resulting in serious property damage and / or serious bodily injury.

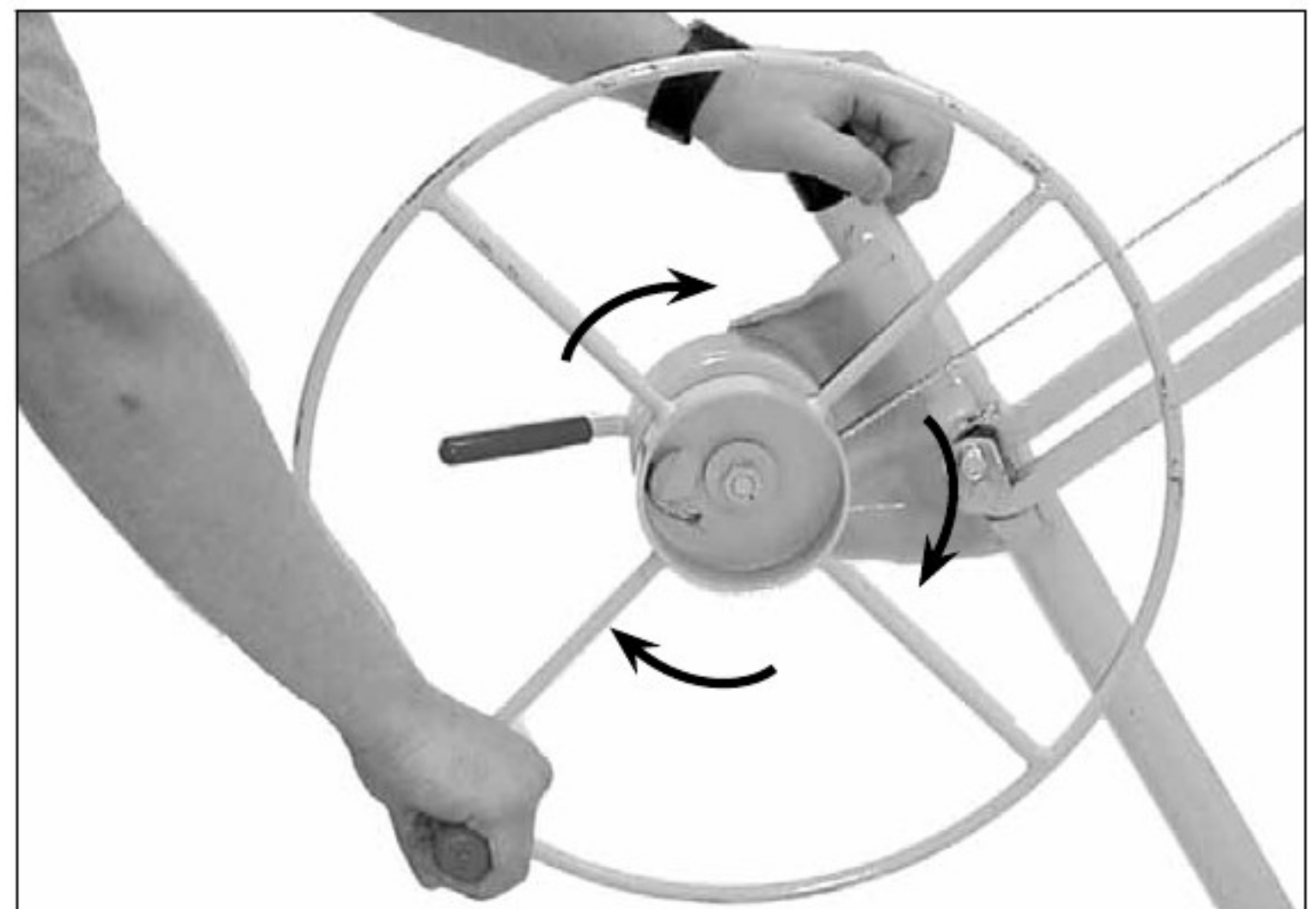

10. Rotate the winch in the direction shown to take the slack out of the cable.



# CABLE REPLACEMENT INSTRUCTIONS continued

## REINSTALLING the telescoping sections: PANELLIFT® Model 182

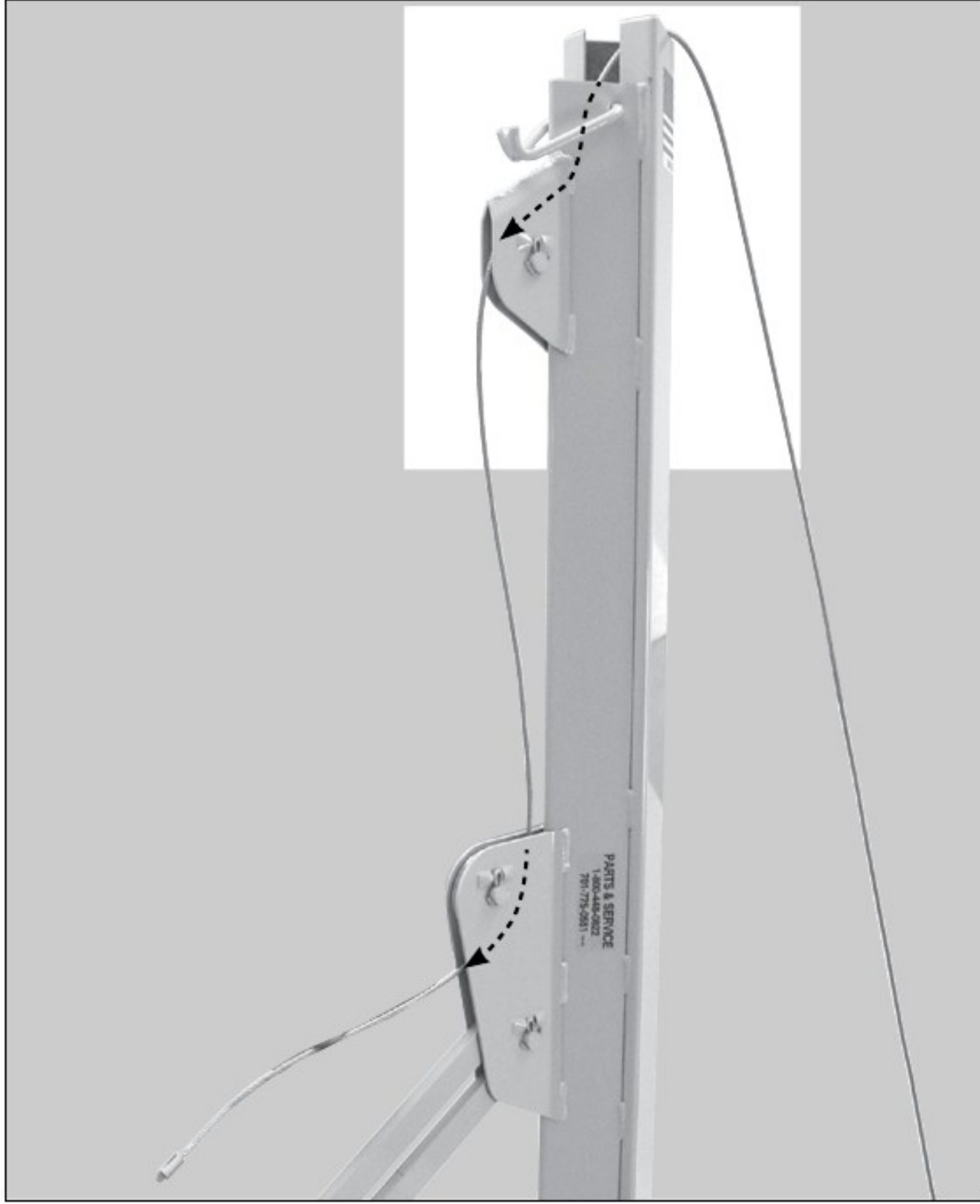

7a. Feed the crimped end of the cable through the upper frame sheave pocket from the top as shown.

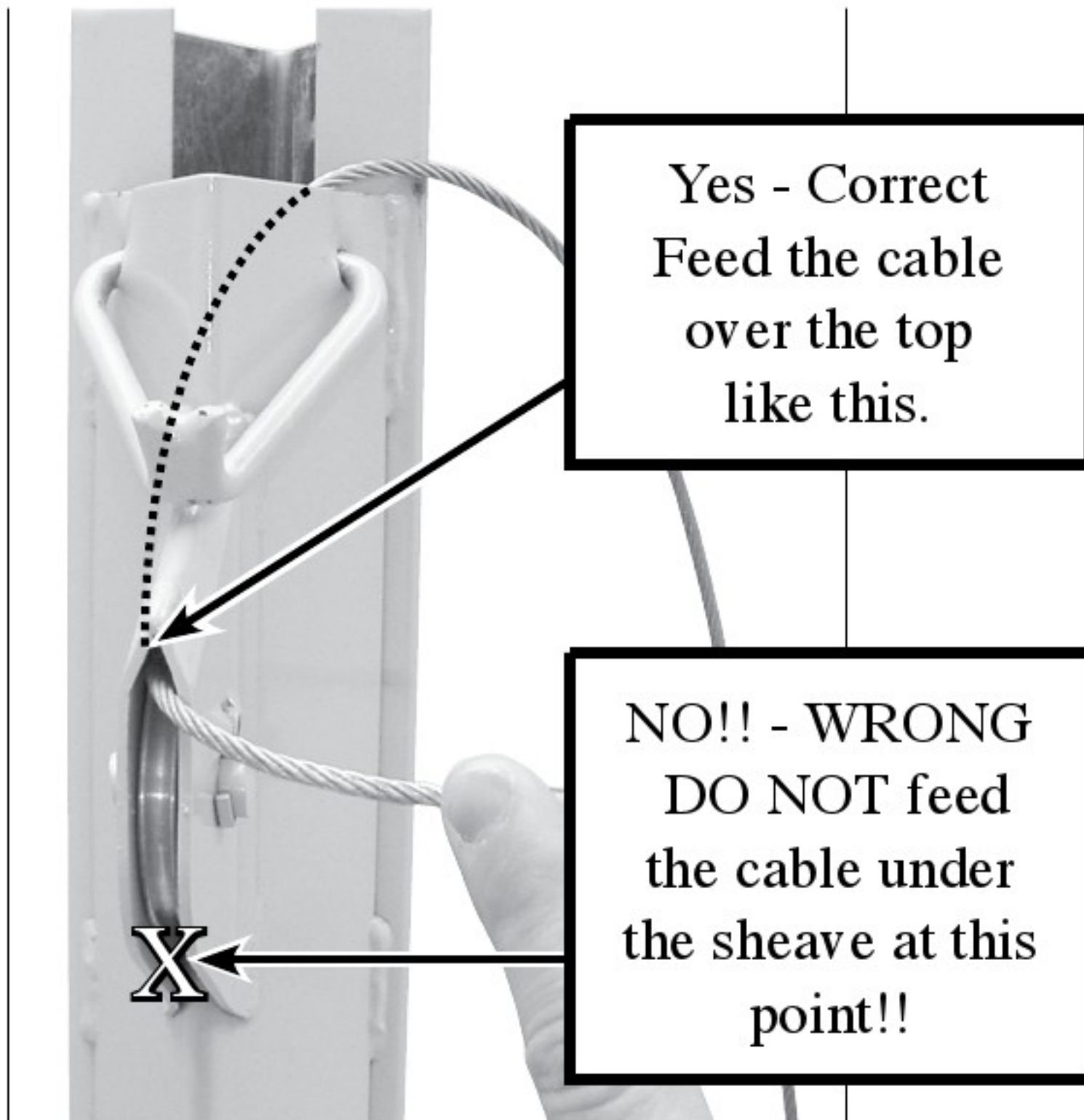

7b. Make sure the cable feeds over the TOP of the upper cable sheave as shown in steps 7a and 7b.

### ⚠ WARNING ⚠

The cable **MUST** feed down from the top of the frame housing and over the top of the upper cable sheave exactly as shown in steps 7a - 7b in order to function properly. Failure to install the cable correctly as shown can cause wearing of the cable for which it is not designed which can result in failure of the cable. Failure of the cable while the lift is raised will result in a sudden and rapid lowering of the lift and the load possibly resulting in serious property damage and / or serious bodily injury.



DO NOT feed the cable under the upper cable sheave on the frame as shown in this photo!



# CABLE REPLACEMENT INSTRUCTIONS continued

## REINSTALLING the telescoping sections: PANELLIFT® Model 182



8a. Feed the crimped end of the cable through the lower frame sheave pocket from the top and out the bottom as shown.

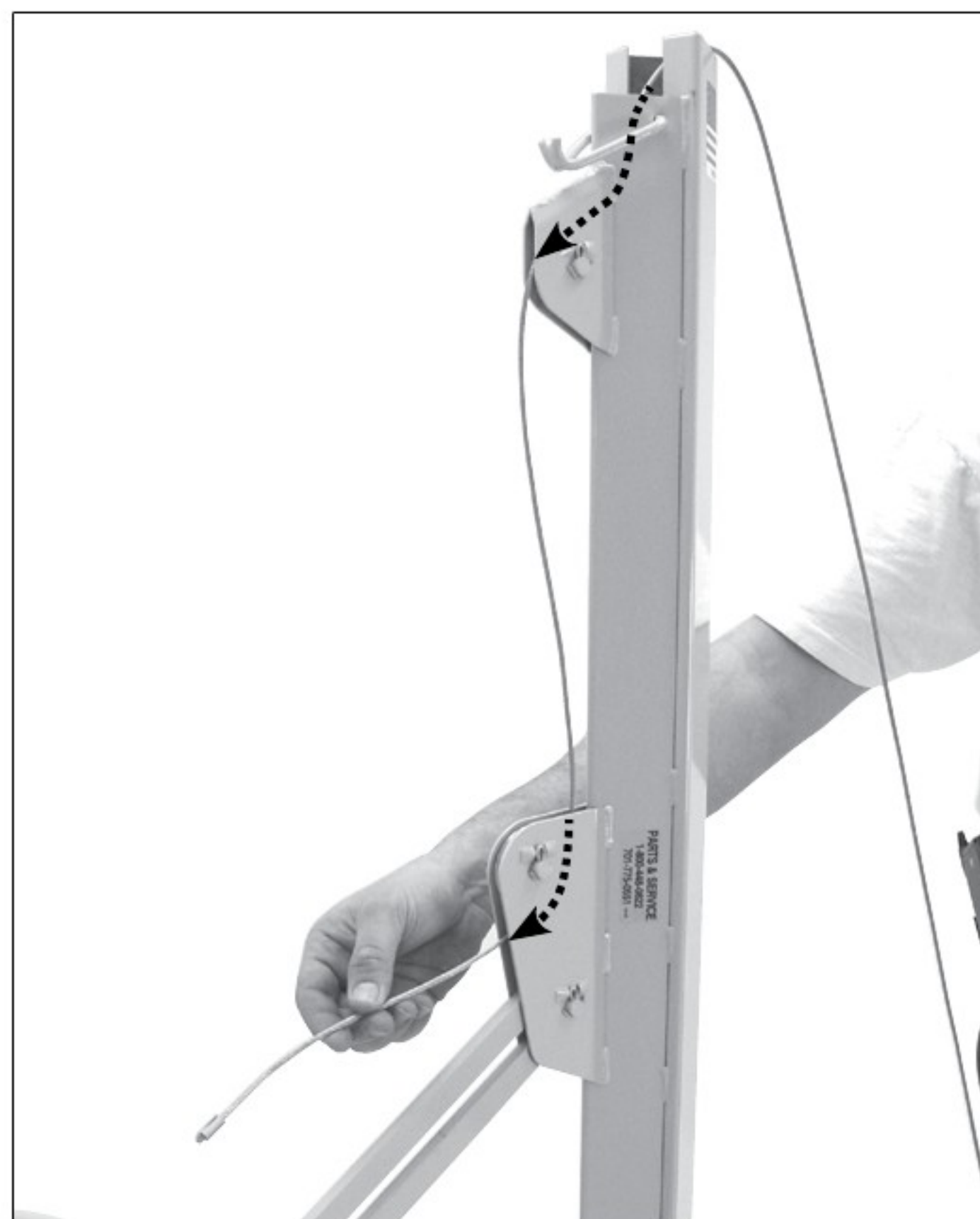

8b. A correctly threaded cable for the Panellift® Model 182 is shown above.



9. Pull the slack cable through the sheave pocket toward the winch and slide the telescoping sections into the frame housing. As the telescoping sections lower into the frame housing, the slack cable will be drawn back through the sheave pocket. Secure the cable correctly to the winch as shown in steps 9 - 10 on page 12